

Extrusions

- E1-60-180 : 57 pcs
- E2-60-180 : 57 pcs
- E3-60-180 : 46 pcs

Connectors

- C-R-60 : 18 pcs
- C-T-60 : 10 pcs
- C-S-60 : 6 pcs
- C-C-60 : 27 pcs
- CF1-60 : 9 pcs

Specifications

Triangles - 100 pcs
Weight - 810.00 kg
Size(LxWxH) - 5.2 x 10.8 x 5.4m

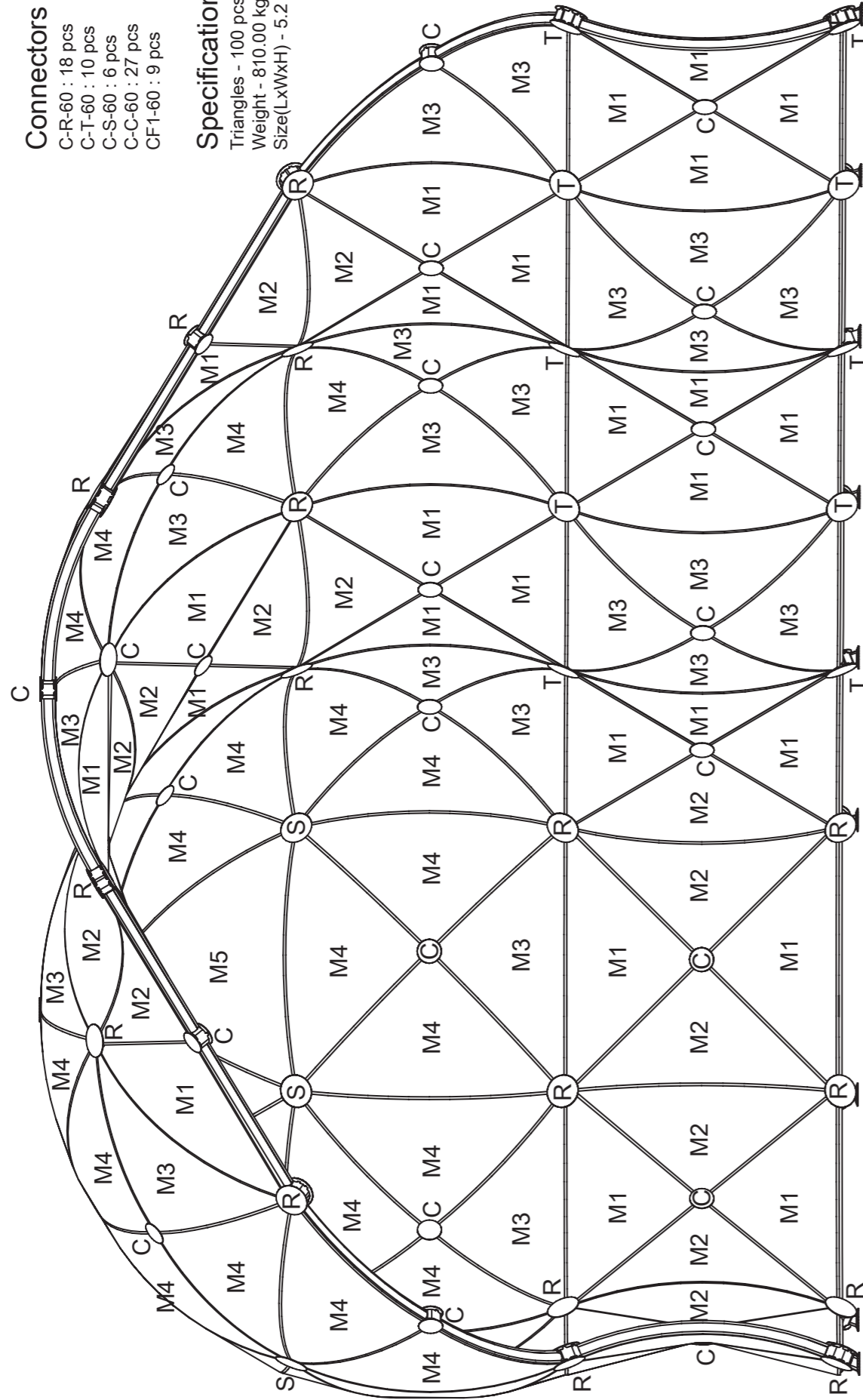

INFINITYCONST evo

A-180

インフィニティCONST エボ
A-180

基本モジュール A180

M1

三角モジュール A180 M1
Triangular Module A180 M1

Material: Aluminium, Steel
Weight: 21,75 kg

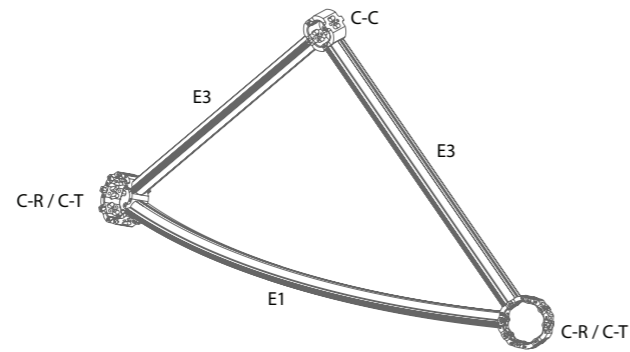

M2

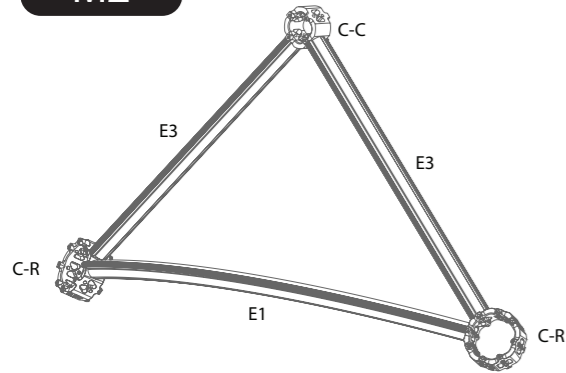

三角モジュール A180 M2
Triangular Module A180 M2

Material: Aluminium, Steel
Weight: 21,75 kg

M3

三角モジュール A180 M3
Triangular Module A180 M3

Material: Aluminium, Steel
Weight: 22,11 kg

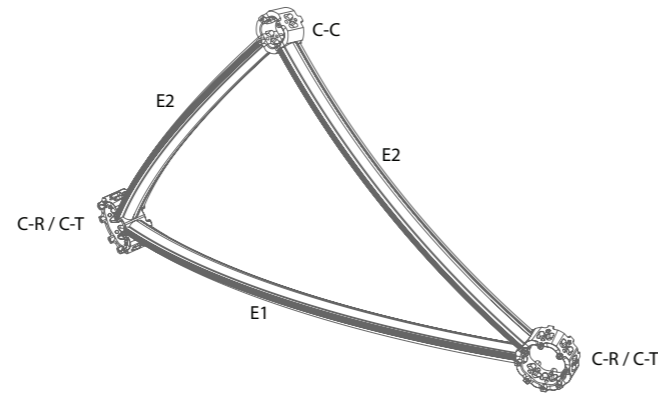

M4

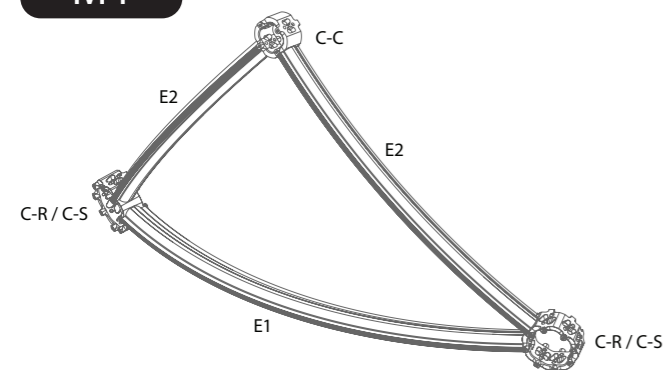

三角モジュール A180 M4
Triangular Module A180 M4

Material: Aluminium, Steel
Weight: 22,11 kg

基本モジュール A180

M5

三角モジュール A180 M5
Triangular Module A180 M5

Material: Aluminium, Steel
Weight: 26,31 kg

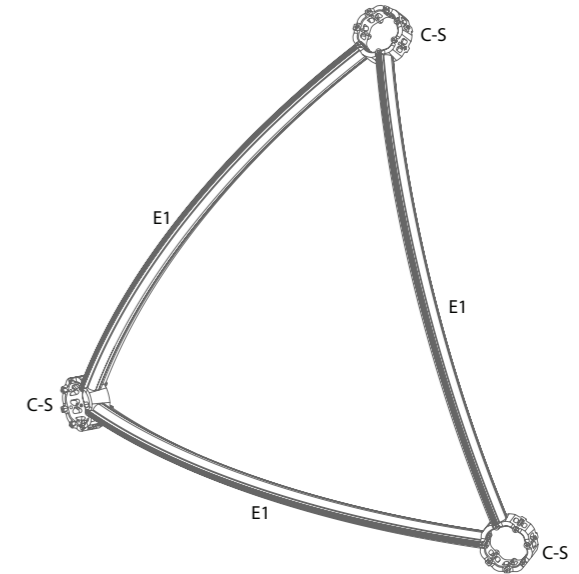

部品構成 A180

フレーム

アルミ材 A180 E1
Curved Aluminium Extrusion

Material: Aluminium
Weight: 4,46 kg

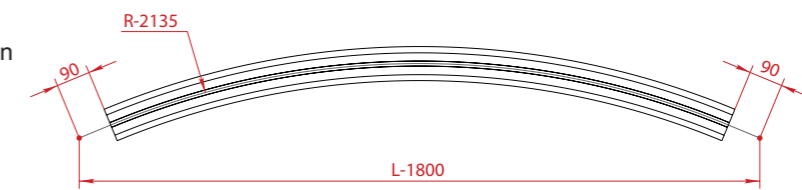

アルミ材 A180 E2
Curved Aluminium Extrusion

Material: Aluminium
Weight: 3,17 kg

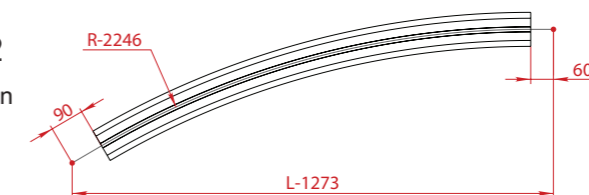

アルミ材 A180 E3
Aluminium Extrusion

Material: Aluminium
Weight: 2,99 kg

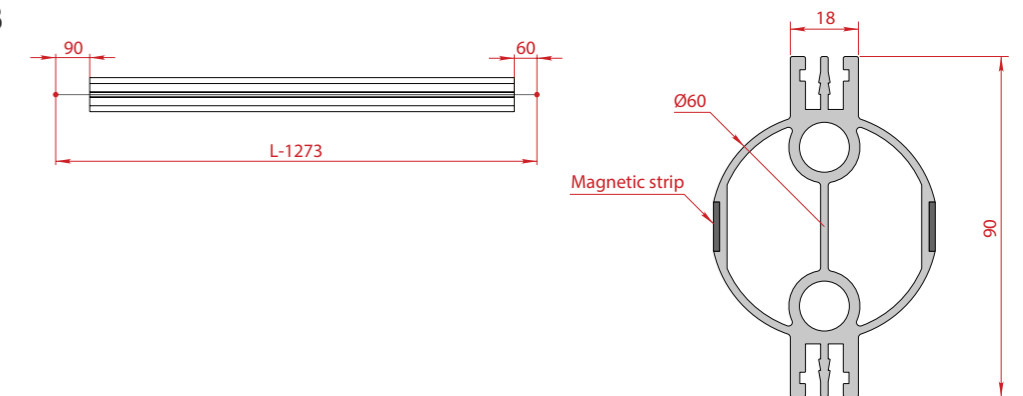

部品構成 A180

コネクタ

コネクタ レボリューション
C-R-60
for extrusions Ø60

Stainless steel AISI 321
Weight: 4,15 kg

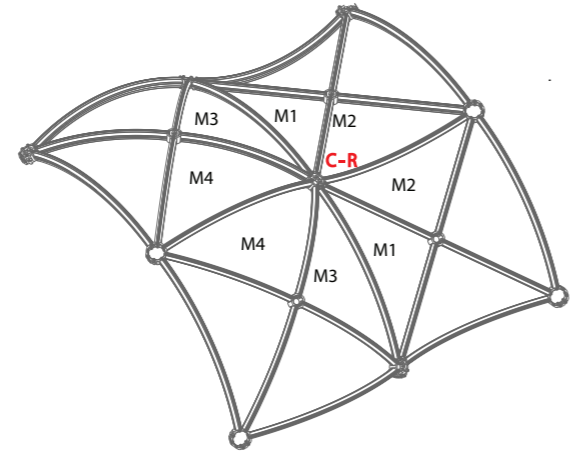

コネクタ トランスレーション
C-T-60
for extrusions Ø60

Stainless steel AISI 321
Weight: 4,15 kg

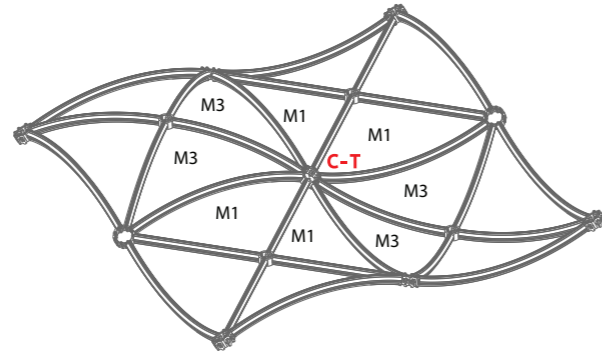

コネクタ スフィア
C-S-60
for extrusions Ø60

Stainless steel AISI 321
Weight: 4,31 kg

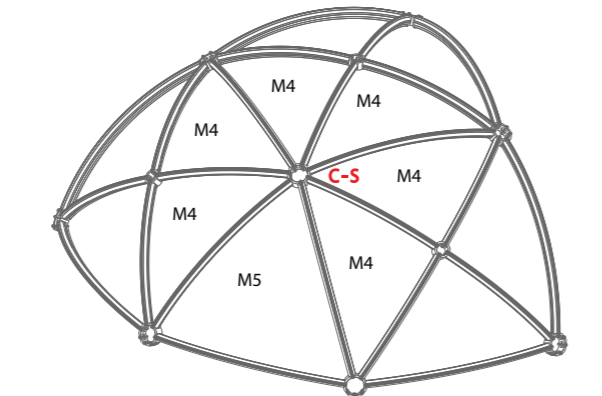

コネクタ センター
C-C-60
for extrusions Ø60

Stainless steel AISI 321
Weight: 3,01 kg

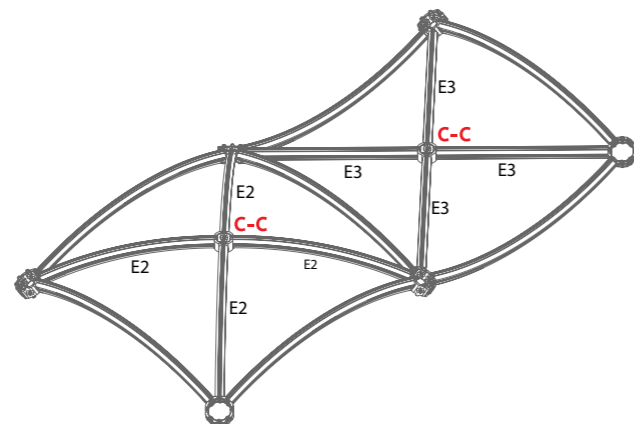

アクセサリ A180

コネクタフット

コネクタ フット
CF1-60
Foot for connectors RTS

Material: Stainless steel AISI 304 and Aluminium
Weight: 1,58 kg

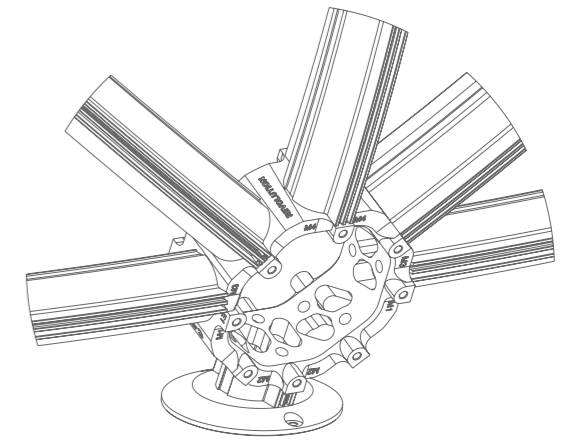
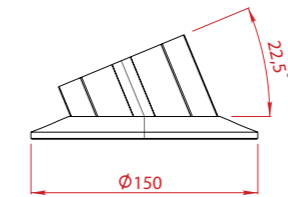

コネクタカバー

コネクタC-R/C-T/C-S用
CC2-RTS-60

Material: Steel · PVC
Weight: 0,85 kg

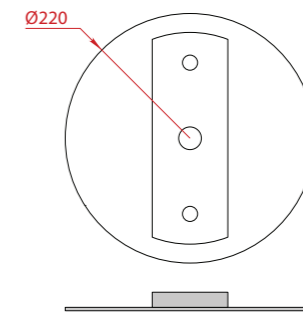
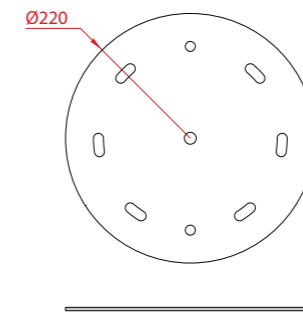

コネクタC-C用
CC2-C-60

Material: Steel · PVC
Weight: 0,46 kg

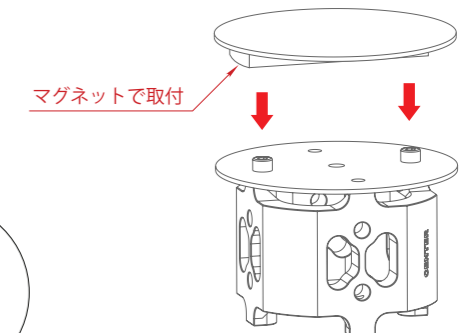
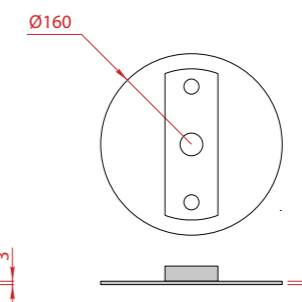
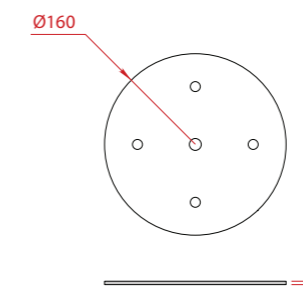

補強パーツ A180

補強ブレス

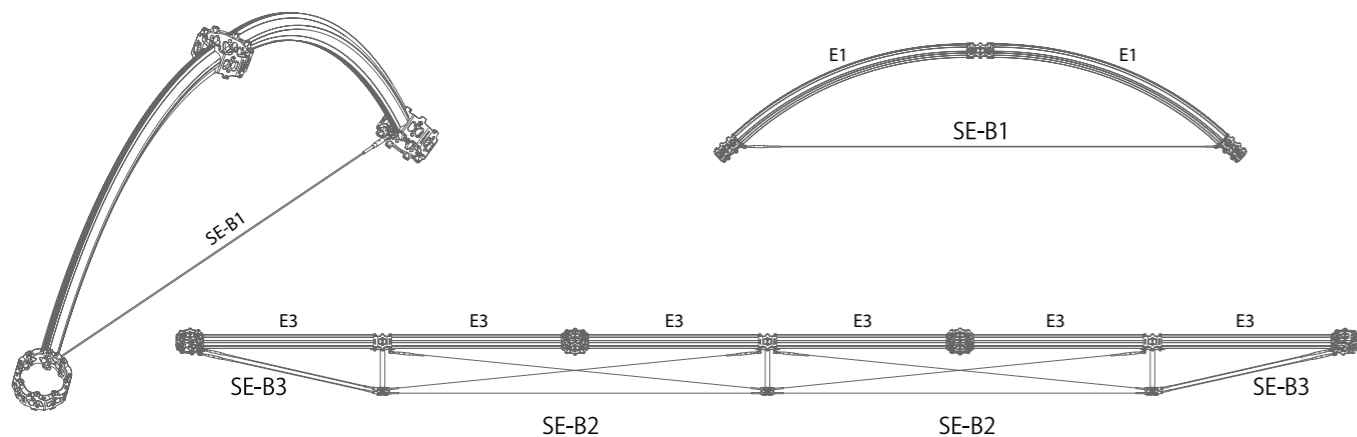

SE-C30
Console L-300mm
Stainless steel AISI 304
Weight: 2,05 kg

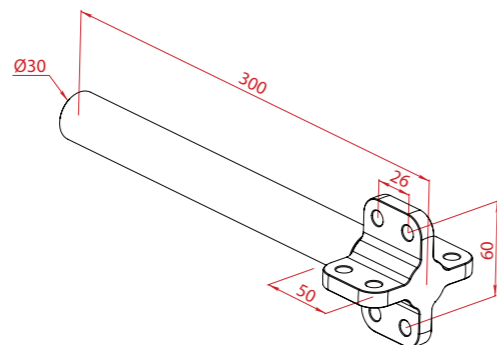

ストレッチ布 A180

スタンダードタイプ

F1-4 (M1 ~ M4共通)
For modules M1, M2, M3, M4

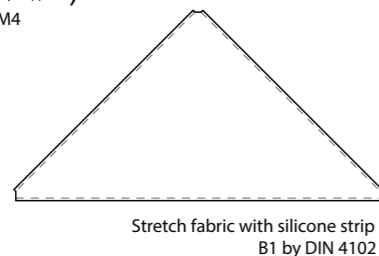

F5 (M5用)
For module M5

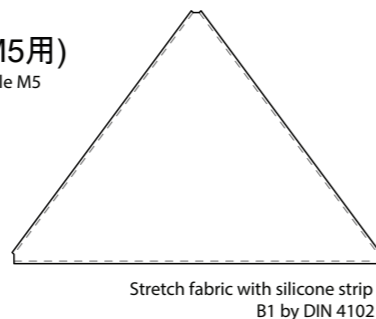

オープンタイプ

F1-4 (M1 ~ M4共通)
For modules M1, M2, M3, M4

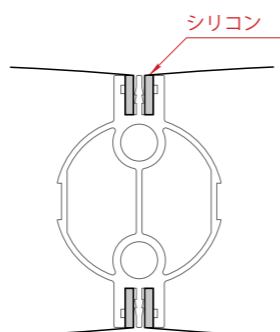
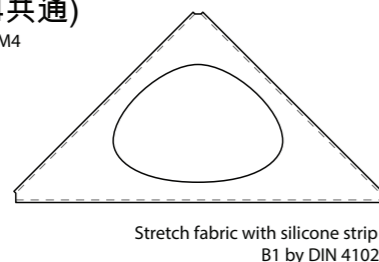

カラーLEDシステム A180

LEDストリップ 24V

L1-24 L1500mm (A180-E1用)

Material: Leds on Magnetic strip
Weight: 0.19kg

L2-24 L1000mm (A180-E2/E3用)

Material: Leds on Magnetic strip
Weight: 0.12kg

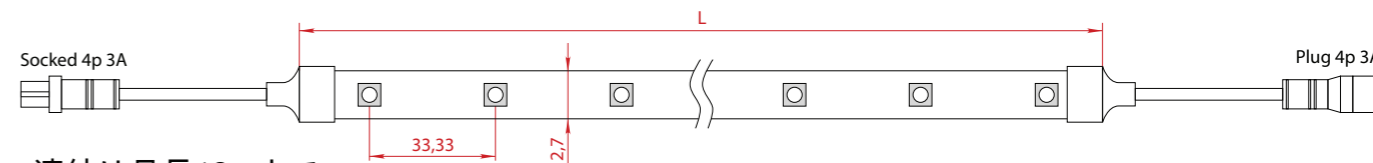

連結は最長12mまで
RGB 24V DC IP 65 | 30 leds/m | 6,1W/m | on magnet | max. 12m in series

LEDコントロールボックス

L3-1500-24

LED Control panel 1500W 24V in stainless steel case

POWER INPUT - 100-240V AC 1500Wt 20A

4 RGB OUT channels 24V DC 360Wt 15A

1 DMX IN
1 DMX OUT

Dimension: 430x260x140 mm
Weight: 11,6 kg

製品仕様

電源: 100-240V 1500W 20A
RGB出力x4系統 DMX512対応
各系統あたりA180の場合16トライアングル点灯可 (64トライアングル/台)
DMXケーブルにてコントロールパネルの連動可能
外形寸法: 430x260x140mm

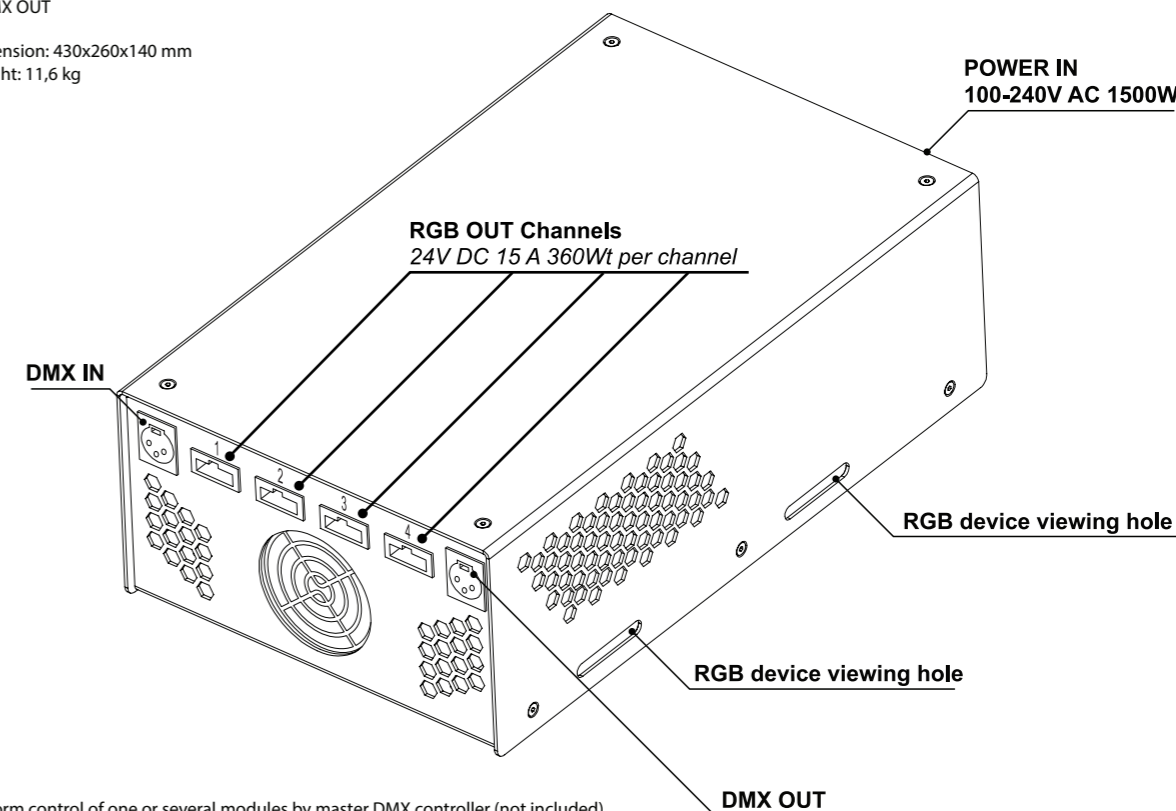

Uniform control of one or several modules by master DMX controller (not included)
Recommended master DMX controllers: Nicolaudie STICK-DE3 and SLESA-U8